



# Hot Powder

Specialty Beverage Dispenser



# Hot Powdered Specialties more flavors... more choices

## Clear View™ Hoppers

Large (5 lb/2.25 kg), Clear View™ hoppers for fast product level visibility.



PIC 2, PIC 3, PIC 5, PIC 6

## Safe... Not Sorry

Patented safety rib on dispense nozzle and generous cup clearance assures cups don't catch.



All Models

## Direct Drive Hoppers

Self-aligning pin & link hopper drive for durability and easy install.



PIC 1, PIC 2, PIC 3, PIC 5, PIC 6

## Model PIC 33A



Compact 12" width!

## Coffee ~ Fast & Fresh



Serve fresh, hot coffee with a touch of soluble coffee.

## Options:

### Graphics



Choose from our enticing graphics library or ask about custom graphics\* from your art.

PIC 1, PIC 2, PIC 3

### Dispense Style

The choice is yours...



- Manual Flow
- Single Portion per head



- Three portion sizes per head plus "top-off"

PIC 2, PIC 3

Cup Counters\* provide sales tracking and category management data.

Drink Strength Adjustment\* behind drip trays offers easy access to drink settings for recipe changes.



Standard units include drink strength adjustments on control board.

PIC 2, PIC 3

### Hopper Pinwheels

Choose:

Single Pinwheel for most applications



Dual Pinwheel (Products that tend to bridge or sticky products)

No Pinwheel (Heavy products that pack densely)

PIC 1, PIC 2, PIC 3, PIC 5, PIC 6

\* additional cost applies

# ty Beverage Dispensers

## oices... more customers

### Model PIC 1



### Curb Appeal

Draw more attention and sales with large, bold, front-lit graphics.

- Easy change graphics
- Easy access lighting



All Models

### Labor Saving Hoppers

Large (6.5 lb/3 kg) Clear View™ hoppers require less frequent filling.



PIC 1 - 2005 Model

### Hot-Quick

Optional 2500 Watt heater offers extra quick recovery for added capacity.



PIC 2, PIC 3, PIC 4, PIC 5, PIC 6

### Fresh!



All Models

coffee - soluble our option.

Compact 7" width!

#### Auger Springs

718 pitch - large throws  
531 pitch - medium throws  
406 pitch - small throws

#### Key Lock\*

on door offers added security.

#### 4" - 5" Legs\*

offer easy access to clean under machine.

#### Auger Motors

Fast speed (145 RPM) for larger dosage. (standard)  
Slow speed (30 RPM) for small dosage. (soluble coffee)

### Customized Cup Clearance

Choose a spout (all models) and tray (PIC1, PIC2, PIC3) to best fit your cup size.

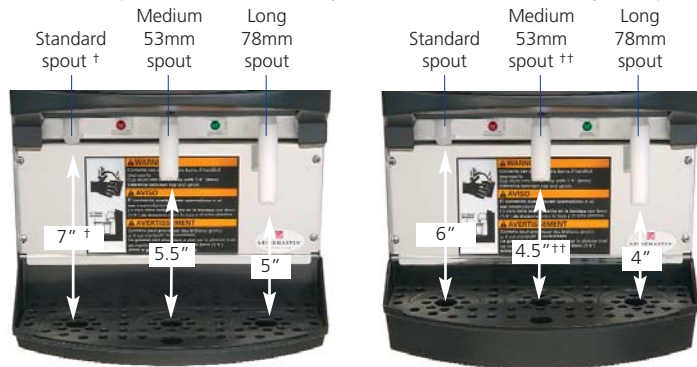

Shallow Tray †

Tall Tray ††

† = std on 120V/60Hz & 120/240V, 60Hz Models

†† = std on 230V/50Hz Models & all PSD Soup Models

### Water - Anytime, Anywhere

With our water pump accessory

Allows machine to operate from remote water supply such as 5 gallon water bottles.



Also available with pump built into machine on PIC 2 and PIC 3.

All Models

ocolate • soup • hot apple cider • flavored cappuccinos • cappuccino

## Model PIC 5



### 270° Attraction

Optional full coverage side merchandisers and large, bold front-lit graphics attract customers and sales.



### Hit the Mark Every Time



Curved panel and cup guide on tray allow easy self-service.

### High Capacity Low Cost Operation

Insulated, high capacity water tank for peak demand, economically operates at 75W\*.

\* 75W standby



## Model PIC 6



## Model PIC 4



Compact 16.5" width!

### Focus Flavor Hopper

4 generous hoppers include 1 extra large (11.5 lb/5.2 kg) Focus Flavor™ hopper and 3 large (5.5 lb/2.5 kg) hoppers.

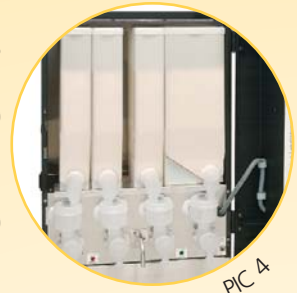

PIC 4

### Curb Appeal

Draw more attention and sales with large, bold, front-lit graphics.

- Easy change graphics
- Easy access lighting



All Models

### Safe... Not Sorry

Patented safety rib on dispense nozzle and generous cup clearance assures cups don't catch.



All Models

## Options:

### Dispense Style

*The choice is yours...*



- Manual Flow †
- Single Portion per head †

† Available with or without hot water option\*.



- Three portion sizes per head plus "top-off"

PIC4

### Hot Water Dispense

Prepare a variety of food & drinks - the possibilities are endless...



PIC4

### Coffee Fresh & Fast

Serve fresh, hot coffee - FAST - using your soluble coffee with our soluble coffee option.



All Models

### Water - Anytime, Anywhere

With our water pump accessory

Allows machine to operate from remote water supply such as 5 gallon water bottles.



All Models

\* additional cost applies

chocolate • cappuccino • chai tea • steamed milk • gourmet hot co

**Specification Sheets Available by Model on our Full Line of Powdered Specialty Beverage Dispensers:**

<p>Choice of graphics on PIC1, PIC2, PIC3</p> 	 <p><b>PIC1 Series</b></p>	 <p><b>PIC2 Series</b></p>	 <p><b>PIC3 Series</b></p>
<p><b>Electrical &amp; Listings</b></p>	<p>PIC/PSD: 120V/60Hz, 1650W, 14A (UL, NSF)          PIC/PSD-CUL: 120V/60Hz, 1400W, 12A (CUL, UL, NSF)          PIC/PSD-Q: 120/240V, 60Hz, 2500W, 10.5A (UL, CUL, NSF)          PIC/PSD-E: 230V, 50/60Hz, 2300W, 10A (CE, NSF)</p>		
<p><b>Water Line</b></p>	<p>1/4" (6.35mm) flare</p>	<p>1/4" (6.35mm) flare</p>	<p>1/4" (6.35mm) flare</p>
<p><b># Hoppers/Sizes</b></p>	<p>1 (6.5 lb/3 kg)</p>	<p>2 (5 lb/2.25 kg each)</p>	<p>3 (5 lb/2.25 kg each)</p>
<p><b>Tank Size</b></p>	<p>1.5 gallons (5.7 L)</p>	<p>3.5 gallons (13.2 L)</p>	<p>3.5 gallons (13.2 L)</p>
<p><b>Cup Clearance</b></p>	<p>PIC1/PIC1-Q/PIC1-CUL: 7" (18 cm) std          PIC1-E &amp; All PSD1: 4.5" (11.4 cm) std</p>	<p>PIC2/PIC2-Q/PIC2-CUL: 7" (18 cm) std          PIC2-E &amp; All PSD2: 4.5" (11.4 cm) std</p>	<p>PIC3/PIC3-Q/PIC3-CUL: 7" (18 cm) std          PIC3-E &amp; All PSD3: 4.5" (11.4 cm) std</p>
<p><b>Dimensions (H x W x D)</b></p>	<p>25-1/4" x 7" x 22-7/8" (64 cm x 18 cm x 59 cm)</p>	<p>26-1/2" x 12" x 22" (67 cm x 30 cm x 56 cm)</p>	<p>26-1/2" x 12" x 22" (67 cm x 30 cm x 56 cm)</p>
<p><b>Ship Dimensions / Weight</b></p>	<p>29-1/2" x 12-1/2" x 27" / 48 lb          75 cm x 32 cm x 69 cm / 21.8 kg</p>	<p>32" x 16-1/2" x 26-3/4" / 81 lb          81 cm x 42 cm x 68 cm / 37 kg</p>	<p>32" x 16-1/2" x 26-3/4" / 83 lb          81 cm x 42 cm x 68 cm / 38 kg</p>
<p><b>Dispense Style</b></p>	<p>PIC1: manual          PIC1A: single portion control</p>	<p>PIC2: manual          PIC2A: single portion control          PIC2-3A: three portions per head</p>	<p>PIC3: manual          PIC3A: single portion control          PIC3-3A: three portions per head</p>
 <p><b>PIC4 Series</b></p>	 <p><b>PIC5 Series</b></p>	 <p><b>PIC6 Series</b></p>	
<p><b>Electrical &amp; Listings</b></p>	<p>PIC: 120V, 60Hz, 1650W, 14A (UL, NSF)          PIC-CUL: 120V, 60Hz, 1400W, 12A (CUL, UL, NSF)          PIC-Q: 120/240V, 60Hz, 2500W, 10.5A (UL, CUL, NSF)</p>		
<p><b>Water Line</b></p>	<p>1/4" (6.35 mm) flare</p>	<p>1/4" (6.35 mm) flare</p>	<p>1/4" (6.35 mm) flare</p>
<p><b># Hoppers/Sizes</b></p>	<p>4 (three - 5.5 lb/2.5 kg, one - 11.5lb/5.2kg)</p>	<p>5 (5 lb/2.25 kg each)</p>	<p>6 (5 lb/2.25 kg each)</p>
<p><b>Tank Size</b></p>	<p>3.5 gallons (13.2 L)</p>	<p>5 gallons (19L) insulated tank</p>	<p>5 gallons (19L) insulated tank</p>
<p><b>Cup Clearance</b></p>	<p>7" (18 cm) std;          (5.5" or 5" optional with spout extensions)</p>	<p>8" (21 cm) std;          (6.5" or 6" optional with spout extensions)</p>	<p>8" (21 cm) std;          (6.5" or 6" optional with spout extensions)</p>
<p><b>Dimensions (H x W x D)</b></p>	<p>32-1/2" x 16-1/2" x 22"          (83 cm x 42 cm x 57 cm)</p>	<p>34-3/4" - 35-3/4" x 20-1/2" x 24-3/4"          (88-91 cm x 52 cm x 63 cm)</p>	<p>34-3/4" - 35-3/4" x 24-1/4" x 25"          (88-91 cm x 62 cm x 64 cm)</p>
<p><b>Ship Dimensions / Weight</b></p>	<p>38" x 21" x 27" / 100 lb          97 cm x 53 cm x 69 cm / 46 kg</p>	<p>44" x 30-1/4" x 30-1/4" / 130 lb          112 cm x 77 cm x 77 cm / 59 kg</p>	<p>44" x 30-1/4" x 30-1/4" / 160 lb          112 cm x 77 cm x 77 cm / 73 kg</p>
<p><b>Dispense Style</b></p>	<p>PIC4: manual          PIC4A: single portion control          PIC4-3A: three portions per head</p>	<p>PIC5: manual</p>	<p>PIC6: manual</p>



**GRINDMASTER™**  
CORPORATION

Tel (502) 425-4776 • Fax (502) 425-4664 • 1-800-695-4500 (USA & Canada only)